

K4 plus Handpiece 4912

Verk.-Nr. K4 plus 4912
Mat.-Nr. 1.001.8681

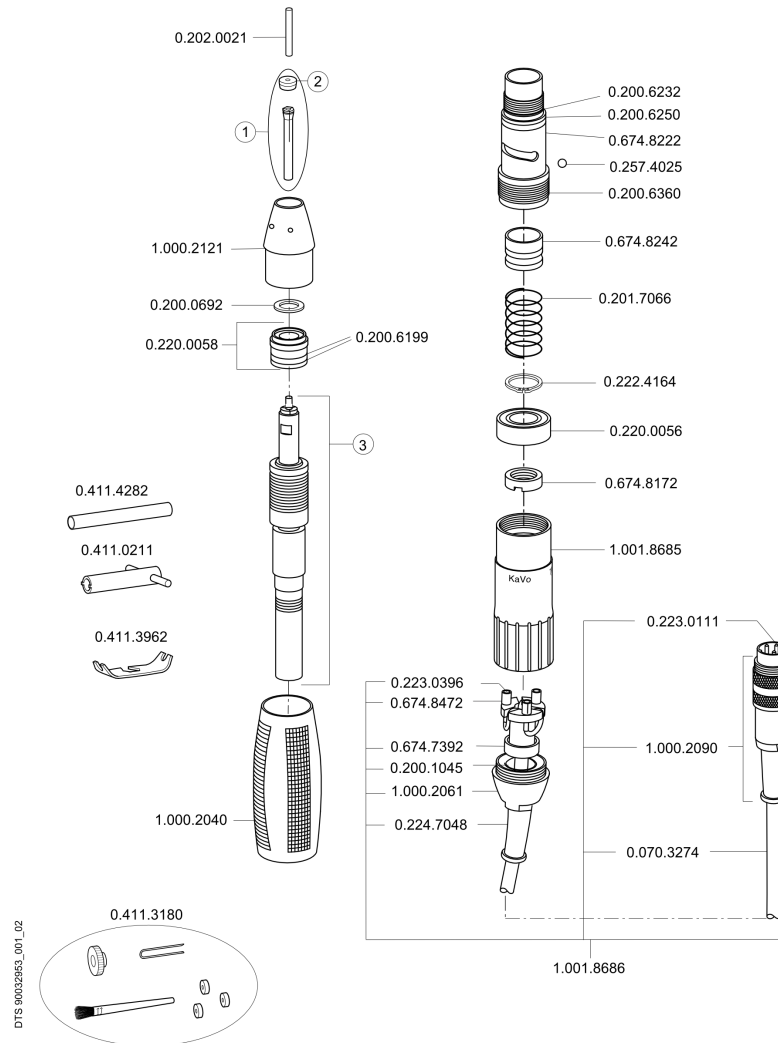

06/2008
01.32
01.37



K4 plus Handpiece 4912

Article no.	Description	Comment
0.674.8172	Nut	
0.674.8222	Housing	
0.674.7392	RING	
0.411.4282	ASSEMBLING BOLT K5	
0.411.3180	MAINTENANCE SET	
0.070.3274	Sheathed cable 3x0,5	
0.674.8242	Thrust piece	
0.674.8472	CONTACT HOUSING 5,5	
1.001.8685	Motor housing K4 plus	
1.001.8686	Connecting cable	
1.000.2121	Nose cone	
1.000.2090	Plug 6-POLE mount.	
1.000.2040	Douille ext. K4 rouge	
1.000.2061	Kappe K4 rot	
0.411.0211	BOX SPANNER K5	
0.411.3962	Spanner	
0.257.4025	BALL	
0.200.6360	O-RING 18x2	
0.200.6232	O-Ring 14x1	
0.200.6199	O-Ring 10,4x0,8	
0.200.0692	Washer 7x11x2 felt	
0.200.1045	WASHER	
0.201.7066	PRESSURE SPRING	
0.200.6250	O-RING	
0.223.0396	Contact bush	10 pcs / pack
0.202.0021	Parallel pin 2,35x40	
0.223.0111	Contact pins	
0.224.7048	Cable bushing	
0.220.0056	Radial ball bearing 10x19x7	
0.220.0058	Ball bearing mount. 7x14,1x7,5	
0.222.4164	LOCK RING K5	

K4 plus Handpiece 4912

Article no.	Description	Comment
0.674.4891	CHUCK 3,175/30	
0.674.4881	CHUCK 3,00/30	
0.674.4871	Chuck 2,35/30	
0.674.8482	Cover	
0.674.8212	Cover	10 pcs / pack
1.006.3347	A-Rotor 1.001.7669 K4+ / K5+	
1.001.7669	Rotor	