

# Operating instructions

## EWL 35 W, 35 T, 35 U-S.



**Always on the safe side.**



KaVo. Dental Excellence.

**KaVo Dental GmbH**

Bismarckring 39

D-88400 Biberach

Tel.: 0 73 51 / 56-0 • Fax: 0 73 51 / 56 -14 88

**Hersteller/manufacturer:**

**Kaltenbach & Voigt GmbH**

Bismarckring 39

D-88400 Biberach



35 W, 35 T, 35 U-S.

**A 1 User information .....2**  
A 1.1 Meaning of the pictograms .....2  
A 1.2 Important information .....2  
A 1.3 Precautions .....2  
A 1.4 Technical data .....3

**A 2 Scope of delivery - Accessories .....4**  
A 2.1 Scope of delivery .....4

**A 3 Mounting and connection .....5**  
A 3.1 Plaster trap 35W .....5  
A 3.2 Plaster trap 35 T .....7  
A 3.3 Plaster trap 35 U-S .....8  
A 3.4 Plaster trap 35 U-S .....9

**A 4 Setting into operation .....10**

**A 5 Maintenance .....11**  
Guarantee conditions .....12  
Spare parts .....13

A 1 User information

A 1.1 Meaning of the pictograms

 Situations where failure to follow the instructions may lead to danger, damage to material or operating faults.

 Important information for operator and engineer.

 Automatic mode  
Automatic sequence

 Close, screw in, fasten, etc.

 Open, release, loosen

+ more, higher

- less, lower

• Continuous operation

 Time, time sequence

 Disconnect mains plug

A 1.2 Important information

 The instructions for use should be read by the user before starting up the unit for the first time, in order to avoid incorrect operation and other damage. If other language versions are required, please request these from your responsible KaVo agent. Duplication and distribution of the instructions for use (IU) require KaVo's prior consent.

All technical data, information and properties of the product described in the IU correspond to the state on going to press.

Modifications and improvements to the product as a result of new technical developments are possible.

This does not imply any right to retrofitting of existing units.

KaVo assumes no responsibility for damage arising through:

- external influences (poor quality of the media or inadequate installation)
- use of incorrect information
- improper use
- improperly performed repairs.

Repair and maintenance work - apart from the activities described in these instructions for use - may be performed only by qualified technical personnel.

In the event of modifications by third parties, the approvals become null and void. KaVo recommends using only original spare parts for operation and for repair.

A 1.3 Precautions

Safe operation and protection of the unit are ensured only through proper use in accordance with the instructions for use and using the tools approved for the purpose. The following should also be observed:

- the work safety regulations,
- the accident prevention regulations.

In accordance with these conditions it is the duty of the user:

- 
- to use only flawless working materials,
  - to observe correct usage and applications,

ewl

# 35 W, 35 T, 35 U-S.

## A 1.4 Technical data

### Dimensions:

#### Plaster Trap 35 W

Width: 425 mm  
Depth: 565 mm  
Height: 430 mm

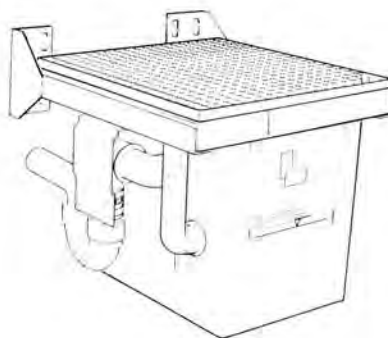

#### PlasterTrap 35 T

Width: 565 mm  
Depth: 565 mm  
Height: 585 mm

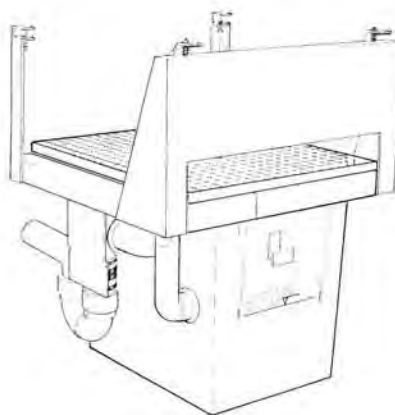

#### Plaster Trap 35 U-S

Width: 560 mm  
Depth: 565 mm  
Height: 400 mm

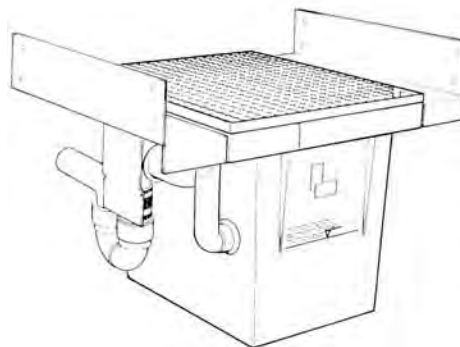

#### Plaster Trap 35

Width: 400 mm  
Depth: 455 mm  
Height: 390 mm

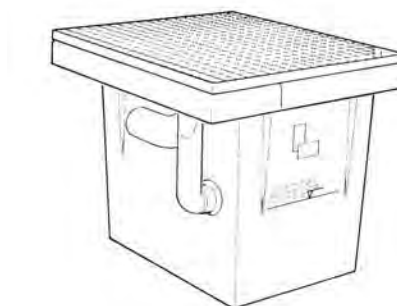

### Capacity

up to maximum level marked: 15 l  
Drain: ø 50 mm

Technische Änderungen vorbehalten.

# 35 W, 35 T, 35 U-S.

## A 2 Scope of delivery - Accessories

### A 2.1 Scope of delivery

Check the completeness of the delivery.

**Plaster Trap 35W**  
consisting of:

- „W“ support with mounting set (7)
- Plastertrap (4)
- Splash-guard grid (2)
- In-flow cover (3)
- Drain (5)
- Pipe clamps with bolted connection (6)
- Connecting piece (1)

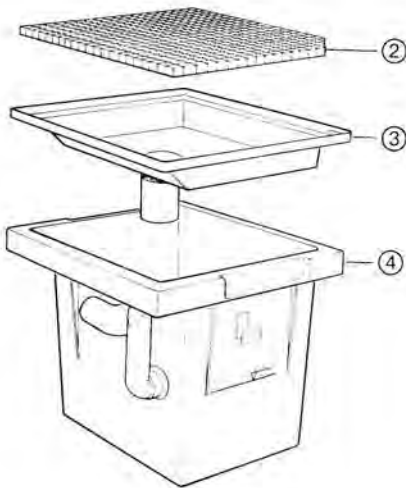

**Plaster Trap 35 T**  
consisting of:

- „T“ support with mounting set (8)
- Plaster trap (4)
- Splash-guard grid (2)
- In-flow cover (3)
- Drain (5)
- Pipe clamps with bolted connection (6)
- Connecting piece (1)

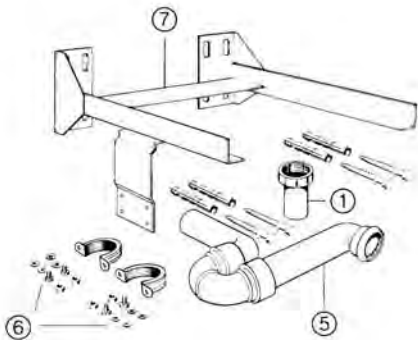

**Plaster Trap 35 U-S**  
consisting of:

- „U-S“ support with mounting set (9) - (10)
- Plastertrap (4)
- Splash-guard grid (2)
- In-flow cover (3)
- Drain (5)
- Pipe clamps with bolted connection (6)
- Connecting piece (1)

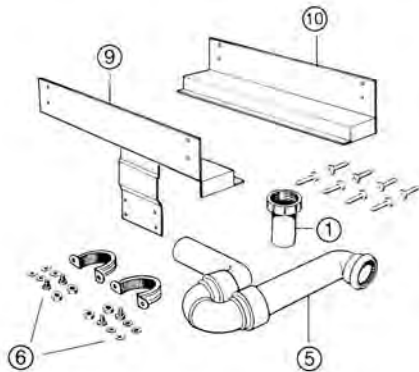
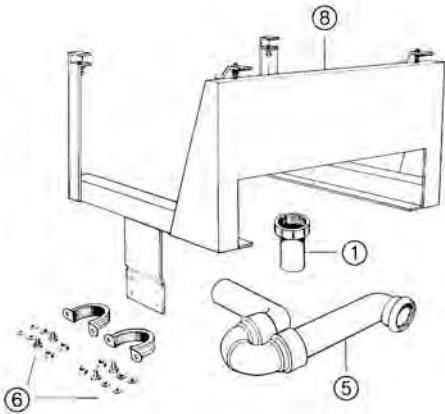

# 35 W, 35 T, 35 U-S.

## A 3 Mounting and connection

### A 3.1 Plaster trap 35W

Hight of drain connection  
in-house installation 330 mm

3.1.1 Measure and mark the mounting  
points **A**.

Measure "X" at a table height  
of 870 mm 450 mm above floor level.

Measure "X" at a table height  
of 950 mm = 530 mm above floor level.

Ensure a minimum lateral spacing between  
plaster trap drain center and the outer edge  
of the support **W** ⑦ of 80 mm.

3.1.2 Drill four 14 mm diameter holes with  
a minimum depth of 90 mm.

**!** Check carrying capacity of the wall.  
Maximum weight of plaster trap  
(clearing plaster, clearing water and dead  
weight) about 42 kg.

Insert wall plugs ⑪. Fix support **W** ⑦  
with the 4 screws ⑫ and 4 washers ⑬.

**i** Should the 4 mounting points **A** not  
provide the necessary stability, then  
the support **W** ⑦ must be additionally  
fixed by another 4 mounting screws, as  
described in 3.1.2.

3.1.3 Attach socket pipe coupler ⑭ to the  
retaining plate ⑮ by means of pipe clamps  
and screws ⑥.

**i** Adjust the socket pipe coupler ⑭ by  
pushing the plaster trap ④ into the  
support ⑦. The screw flange ⑰ must just  
fit in the socket plug coupler ⑭.

3.1.4 Connect the socket pipe coupler  
⑭ with the siphon trap ⑱ and the  
discharge pipe ⑲ and then connect to the  
drain pipe.

**i** The discharge pipe ⑲ can be  
shortened for fitting to the drain pipe.

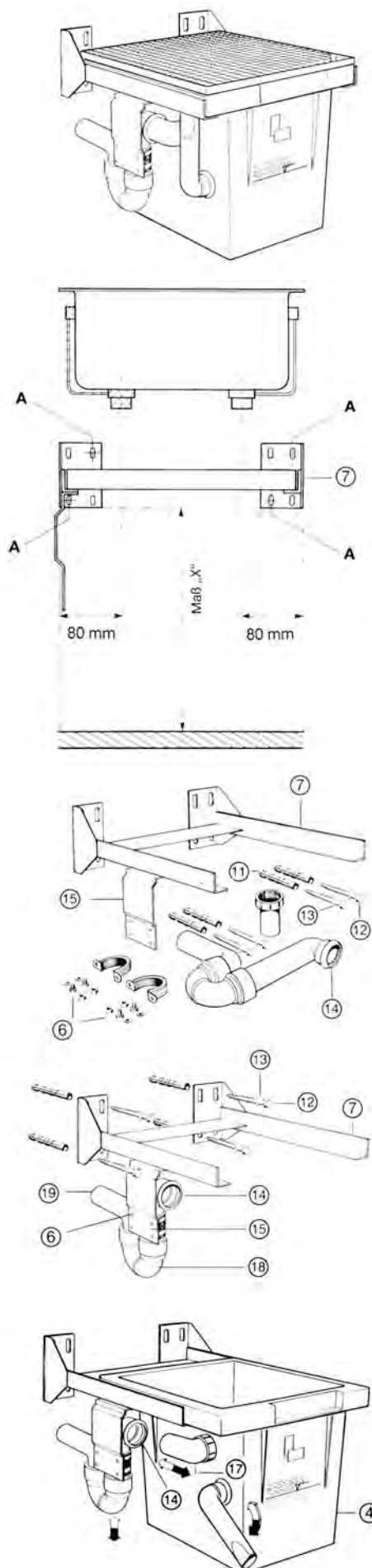

# 35 W, 35 T, 35 U-S.

3.1.5 Insert the in-flow cover ③ in the plaster trap ④ and place the splash-guard grid ② in the in- flow cover ③.

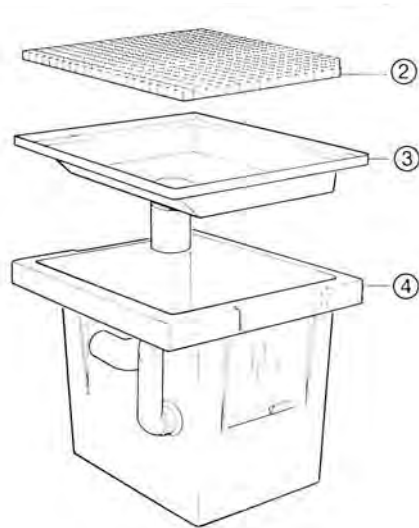

3.1.6 Push the plaster trap ④ into support **W** ⑦.

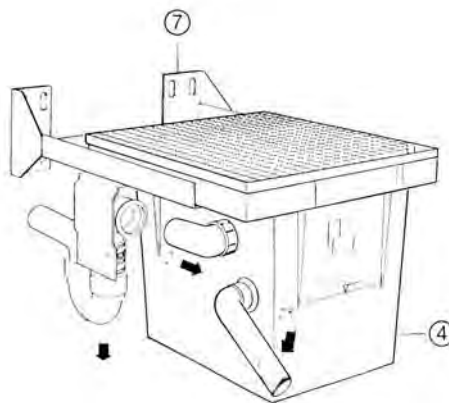

3.1.7 Measure the distance between the plaster trap drain ⑯ and the splash-guard grid ②.

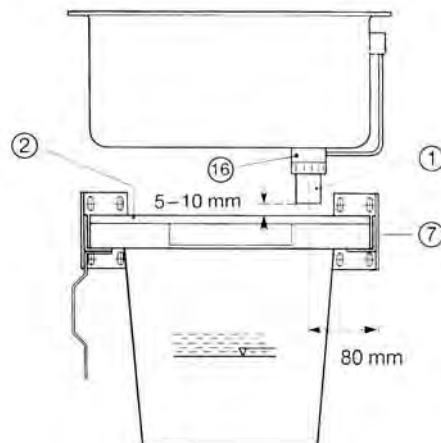

3.1.8 Shorten connecting piece ① so that when it is mounted there will remain a distance of 5 to 10 mm to the splash-guard grid ②.

3.1.9 Screw the connecting piece ① with the set-in seal to the plaster trap drain ⑯.

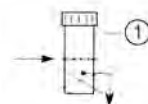



# 35 W, 35 T, 35 U-S.

## A 3.2 Plaster trap 35 T

in plaster and sink benches with bench frame.

### Hight of drain connection

(in-house installation) 330 mm

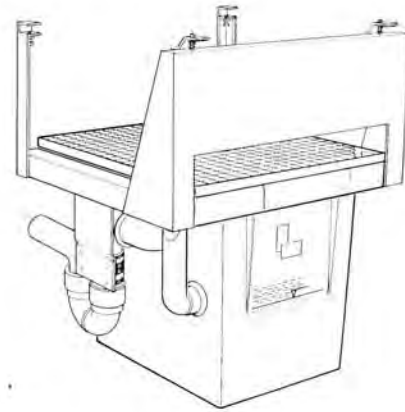

3.2.1 Loosen screw ②②, ②① and mount the support **T** in the bench frame at the middle of the sink resp. at the discharge side of the rinsing bath.

 *The plaster trap I must be mounted in a way that the drained out water from the sink is completely collected.*

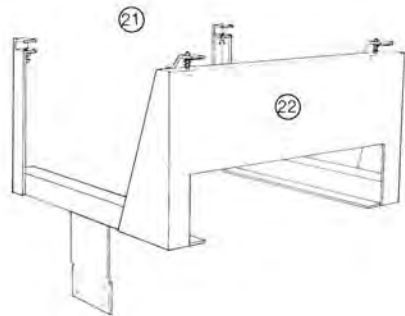

3.2.2 Align support **T** on the front side of the bench frame and screw tightly with screws ②.

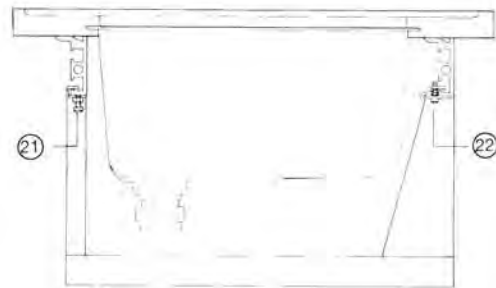

3.2.3 Fix support **T** at the back side of the bench frame by screwing on the screws ②①.

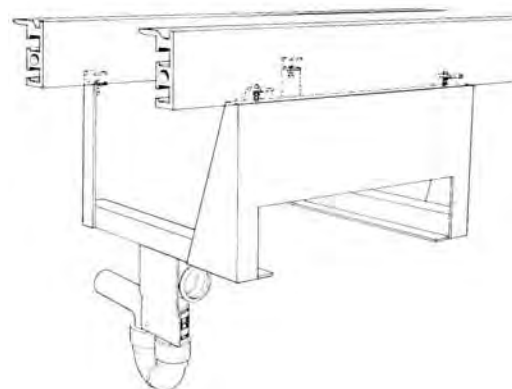

3.2.4 Continue the installation work as described in 3.1 .3 to 3.1.9.

# 35 W, 35 T, 35 U-S.

## A 3.3 Plaster trap 35 U-S

in the  
**suspended cupboards:**  
48 BL,  
48 BR,  
48 D/BL/BR  
and in  
**floor-mounted cupboards:**  
83 BL,  
83 BR,  
83 D/BL/BR,  
91 TL,  
91 TR,  
91 BL,  
91 BR,  
91 D/BL/BR

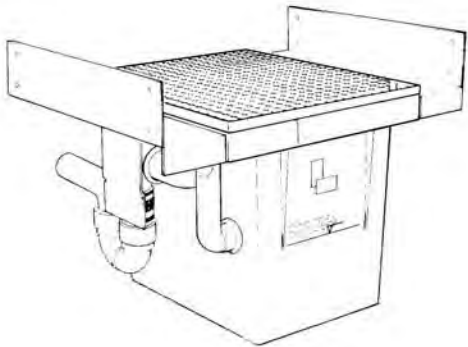

**Hight of drain connection**  
(in-house installation)                      330 mm

3.3.1 Measure and mark the 8 mounting  
points **B**. Measure “X“ for

suspended cupboards  
48 BL, 48 BR, 48D/BL/BR                      159,5mm

floor-mounted cupboards  
83 BL, 83 BR, 83 D/BL/BR                      234,5 mm

floor-mounted cupboards  
91 TL, 91 TR                      245,5mm

floor-mounted cupboards  
91 BL, 91 BR, 91 D/BL/BR                      309,5 mm

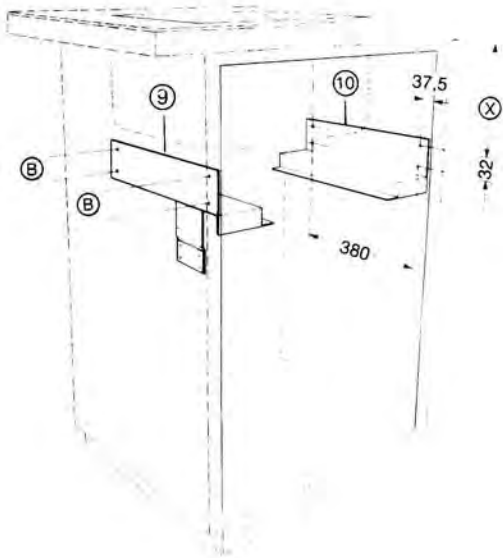

3.3.2 The mounting points **B** in the  
suspended and floor- mounted cupboards  
are pre- drilled (Ø 5 x 14 mm).

3.3.3 Screw on guide rail left ⑨ and right  
⑩ with the supplied set of screws (wood  
screws Ø 6,3 x 16 mm).

3.3.4 Continue the installation work as  
described in 3.1 .3 to 3.1.9.

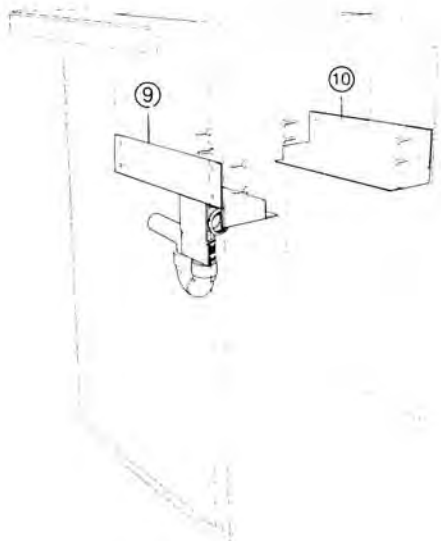

# 35 W, 35 T, 35 U-S.

## A 3.4 Plaster trap 35 U-S

in the floor-mounted cupboards  
83 TL, 83 TR.

 *Mounting in connection with  
STEELDENI-Bench tops  
(stainless steel)*

**Hight of drain connection**  
(in-house installation) 330 mm

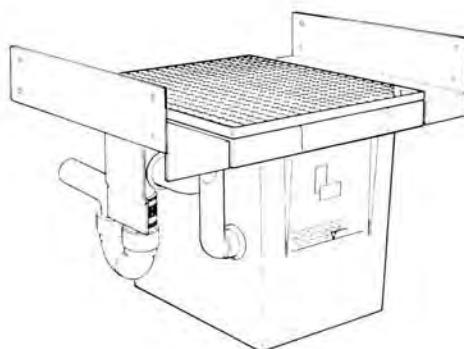

3.4.1 Measure and mark the 8 mounting  
points **C**.  
Measure "X" for floor-mounted cupboards  
83 TL, 83 TR = 202.5 mm

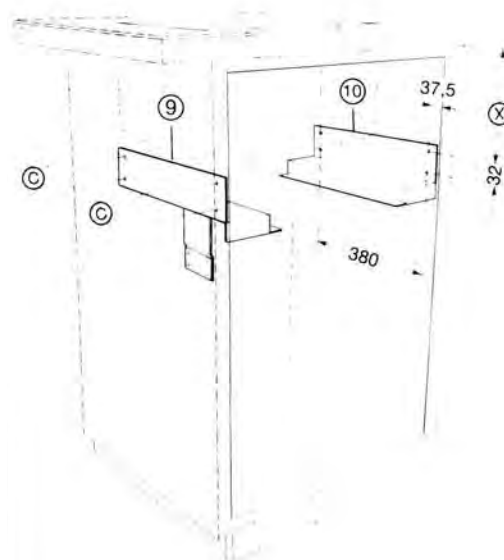

3.4.2 The mounting points **C** in the floor-  
mounted cupboards are pre-drilled  
( $\varnothing$  5 x 14 mm).

3.4.3 Screw on guide rail left ⑨ and right  
⑩ with the supplied set of screws (wood  
screws  $\varnothing$  6,3 x 16 mm).

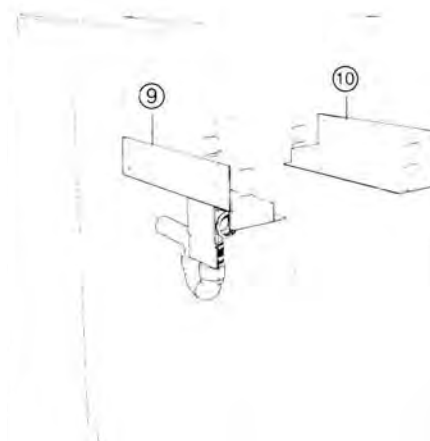

3.4.4 Continue the installation work as  
described in 3.1 .3 to 3.1.9.

 *Guide rail left ⑨ and right ⑩ are  
only for lateral guide (not for  
suspension).  
Plaster trap is put down on the ground of  
the floor-mounted cupboard 83 TL or  
83 TR.*

# 35 W, 35 T, 35 U-S.

## A 4 Setting into operation

Swivel the discharge pipe ⑳ upwards until the stop point is reached.

Fill the plaster trap with water.

The entire water flowing in through the connecting piece ① must be collected in the clarifying tank ④ of the plaster trap.

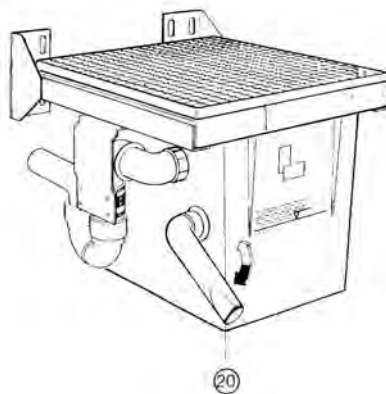

- Check the installation for leakage.
- Check whether the in-house drain pipe can drain off the entire volume of waste water.
- The internal diameter of the drain pipe should not be less than Ø 2".
- Insufficient draining capacity of the drain pipe will cause back swell in the clarifying tank of the plaster trap (danger of flooding).

 Never discharge wax. For discharge of wax and coarse impurities use KaVo Suspended basin insert.

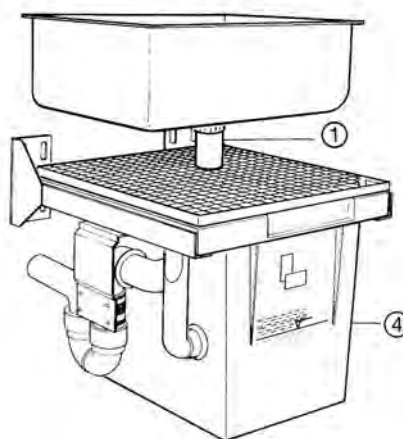

# 35 W, 35 T, 35 U-S.

## A 5 Maintenance

The amount of collected plaster sediment should be checked daily. Allow the water to settle before checking.

**⚠** The plaster trap ④ must be cleaned or emptied when the plaster sediment reaches the maximum level marked on the plaster trap ④.

Emptying or cleaning the plaster trap ④.

Place a pail or similar container of approximately 10-ltr. holding capacity under point of discharge.

Swivel the discharge pipe ②⑩ forwards; drain the waste water out of the plaster trap ④ into the pail.

Swivel the up the discharge pipe ②⑩ until its stop point is reached.

Pull out the plaster trap ④ in the direction of the arrow.

Remove the splash-guard grid ② and the in-flow cover ③.

Discharge the plaster sediment out of the plaster trap ④.

Clean the splash-guard grid ②, the in-flow cover ③, the plaster trap ④ and the screw flange ①⑦.

Replace the in-flow cover ③ in the plaster trap ④, and insert the splash-guard grip ② in the in- flow cover ③.

Push the plastertrap ④ back into the support until the stop point is reached.

**i** The screw flange ①⑦ must just fit into the socket pipe coupler ①④. If necessary, the plug connection should be greased.

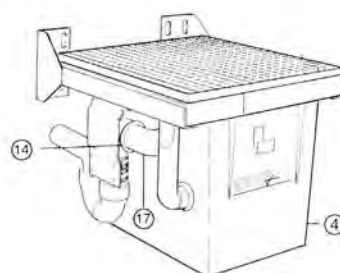
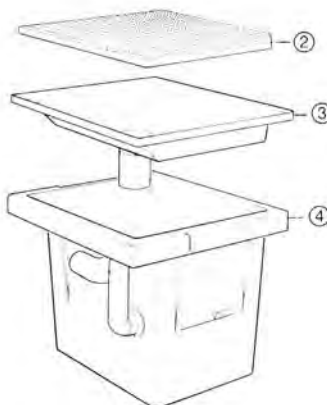
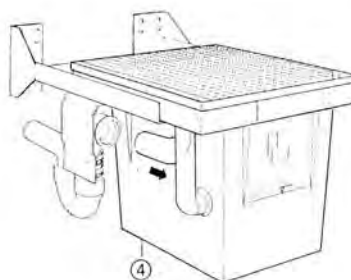
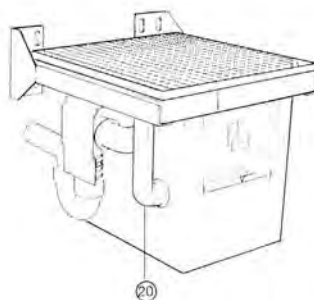

# 35 W, 35 T, 35 U-S.

## **Guarantee conditions**

Within the framework of applicable KaVo delivery and payment conditions, KaVo guarantees proper function, freedom from flaws in material and manufacturing for a period of 12 months from the date of purchase demonstrated by the purchaser.

In case of justified complaints, KaVo will honor its warranty with a free replacement or repair.

The warranty does not cover defects and their consequences that arose or may have arisen due to natural wear, improper handling, cleaning or maintenance, noncompliance with operating, maintenance or connection instructions, corrosion, contaminated media supply or chemical or electrical influences deemed abnormal or impermissible in accordance with factory specifications.

The warranty does not usually cover lamps, light conductors made of glass and glass fibers, glassware, rubber parts and the colourfastness of plastic parts.

The warranty expires when defects or their consequences can arise from manipulations or changes to the product. Warranty claims can only be asserted when they are immediately reported to KaVo in writing.

This notification must be accompanied by a copy of the invoice or delivery note on which the manufacturing number is clearly visible. In addition to the guaranty, the statutory warranty claims of the purchaser also apply with a warranty period of 12 months.

35 W, 35 T, 35 U-S.

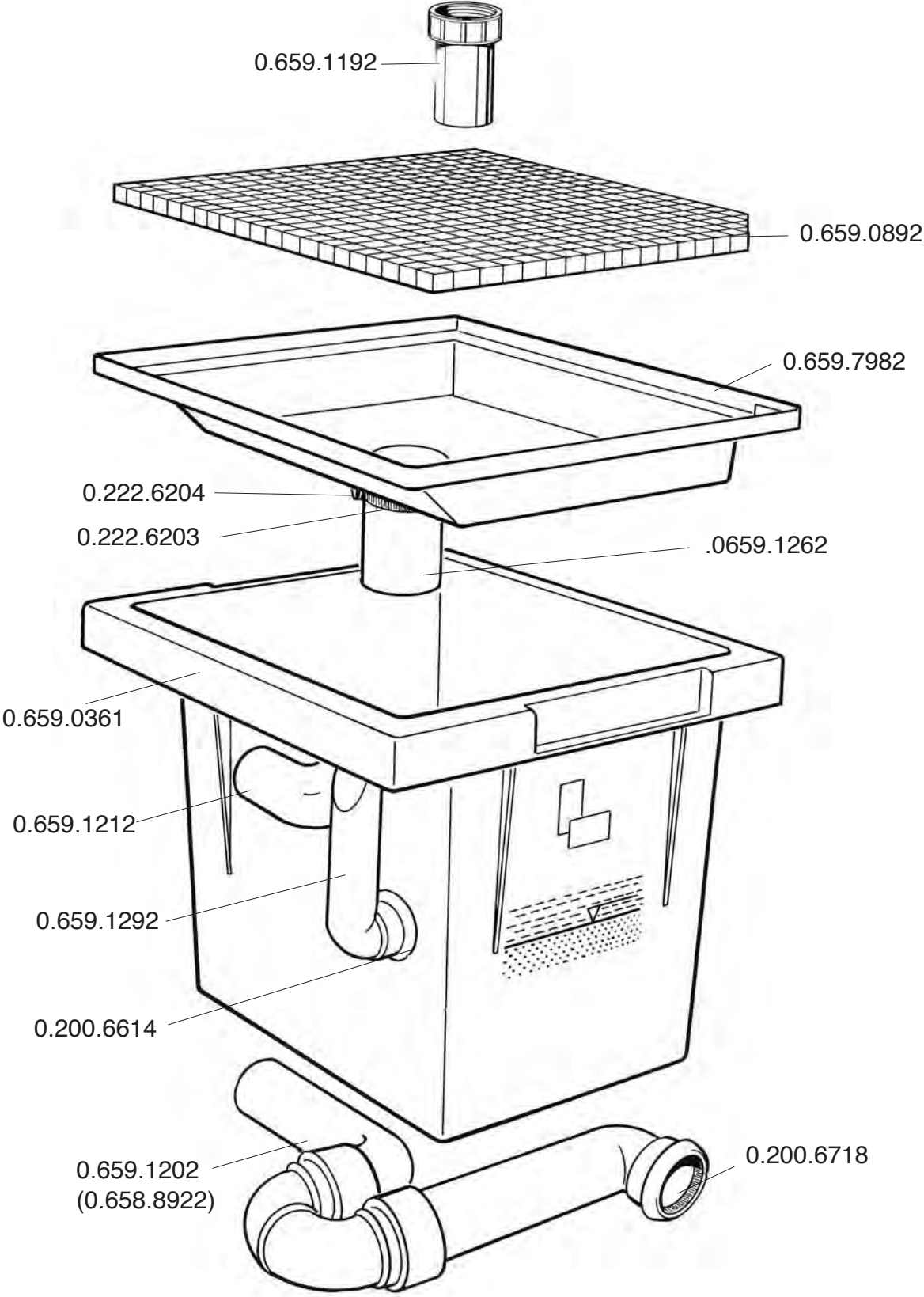



KaVo. Dental Excellence.

KaVo Dental GmbH, D-88400 Biberach/Riss  
Telefon +49 7351 56-0 Fax +49 7351 56-1488  
Internet: [www.kavo.com](http://www.kavo.com)