

Dustex master / Dustex master plus

No. 2626-xxxx

Bedienungsanleitung

Instruction manual • Mode d'emploi

Istruzioni d'uso • Instrucciones para el servicio

Gebruiksaanwijzing • Инструкция по эксплуатации



Renfert GmbH • Industriegebiet • 78247 Hilzingen / Germany
Tel. +49 7731 8208-0 • Fax +49 7731 8208-70
info@renfert.com • www.renfert.com
Made in Germany



0405 21-9955 A

Dustex master / Dustex master plus

Nr. 2626-xxxx

ENGLISH

1. Introduction

We are pleased with your decision to purchase a Renfert Dustex Master or Dustex Master plus dust extractor box.

The Dustex Master and Dustex Master plus are two versions of the same dust extractor box. The Dustex Master is equipped with a base grate while, in the Dustex Master plus, this grating is replaced by an extractor duct.

A *Dustex master* extraction box can be retrofitted with an extraction duct at any time, please refer to the section, „Installing the Extraction Duct „.



Please read the following operating instructions carefully and observe all the information they contain in order to ensure long and trouble-free service.

2. Application Area

In dental technology and clinical laboratories as well as similar professional fields (e.g., goldsmiths, model builders), grinding acrylics, plasters, porcelains, and other materials generates dusts and vapours. The extraction box reduces the effects of dusts and vapours, thus providing improved protection for the operator.

The large openings on the sides offer great freedom of movement, but it is precisely for this reason that the extraction box is not suitable for use with blasting units.

2.1 Ambient Conditions

(in accordance with DIN EN 61010-1)

The unit may only be operated:

- Indoors;
- Up to an altitude of 2,000 m [6,500 ft] above sea level;
- At an ambient temperature range of 5 - 40°C [41 - 104°F] *);
- At a maximum relative humidity of 80% at 31°C [87.8°F], dropping linearly to 50% relative humidity at 40°C [104°F];
- With a mains power supply whose voltage fluctuations do not exceed 10% of the rated value;
- Under over-voltage category II conditions.
- Under contamination level 2 conditions;

*) Between 5 - 30°C [41 - 86°F] the unit can be operated at a relative humidity of up to 80%. At temperatures between 31 - 40°C [87.8 - 104°F] the humidity must decrease proportionally in order to ensure proper operability (e.g., at 35°C [95°F] = 65% relative humidity, at 40°C [104°F] = 50% relative humidity). The unit may not be operated at temperatures above 40°C [104°F].

3. Hazard Information

3.1 Employed Symbols

The following symbols are used in these instructions and on the unit:



Danger

This indicates an imminent risk of injury.



Electrical hazard

There is a risk of electrical shock.



Attention

Failure to observe the associated information can result in damage to the unit.



Note

The operating instructions contain useful information to make handling easier.



Wear eye protection.



Only for indoor use.



Before opening the unit, always disconnect it from the power supply.



Note the operating instructions.

3.2 Hazard Information

The dust extractor cabinet is an electric unit and, as such, carries with it a certain inherent potential electrical hazard.

- The unit may not be operated until it has been modified to comply with the local electrical connection requirements. The necessary alterations may only be performed by a qualified electrician.
- The unit may only be operated if the information on the nameplate conforms with the specifications of your local mains power supply.
- Never operate the dust extractor cabinet without an appropriate extraction system or suitable personal protective clothing, as operating the unit without proper extraction will not provide adequate protection against dusts and vapours which may be hazardous to your health. The type of extraction employed must be appropriate to the dusts and vapours generated during processing. In this regard, please note the requirements of EN 60335-2-69, Attachment AA, or ask your professional organization or regional authority.

- The extraction box is not suitable for use in conjunction with blasting units.
- Improper use of grinding tools in the extraction box carries with it the potential risk of eye and skin injuries.
- Never grind in the direction of your eyes or uncovered areas of skin!
- Never work with the viewing pane open!
- Always wear appropriate eye protection when operating the unit! Failure to wear eye protection can result in eye injuries due to airborne particles.
- Always disconnect the unit from the mains power supply prior to replacing the fluorescent tube.
- Never press on or bend the lamp body during replacement (breakage risk). If necessary, wear gloves or use a cloth.
- Always inspect the electric input lines prior to operation. Units with damaged input lines may not be operated.

3.3 Liability Exclusion

Renfert GmbH shall be absolved from all claims for damages or warranty if:

- The product is employed for any purposes other than those cited in the operating instructions;
- The product is altered in any way other than those alterations described in the operating instructions;
- The product is repaired by other than an authorized facility or if any but Renfert OEM parts are employed;
- The product continues to be employed, despite obvious safety faults or damage;
- The product is subjected to mechanical impacts or is dropped.

4. Installation / Commissioning



Prior to connecting the unit to the mains power supply, compare the information on the extraction box nameplate with the specifications of the local mains power network.

4.1 Setting Up the Unit and Connecting it to an Extractor

Connect the extraction hose to the extraction tube (Figure 1).

4.2 Installing the Fluorescent Lamp



Never press on or bend the lamp body during replacement (breakage risk). If necessary, wear gloves or use a cloth.

1. Insert the fluorescent lamp horizontally (Figure 2).
2. Remove the foil strips from either side of the lamp cover (Figure 3).

3. Plug the lamp cover in (Figure 4).
4. Install and tighten the knurled nuts (Figure 5).

4.3 Commissioning

1. Connect one end of the power cord to the extraction box (Figure 6) and plug the other end into the wall outlet (Figure 7).
2. Switch the unit on (Figure 8).

Your extraction box is now ready for use.

4.4 Installing the Extraction Duct

(applies only to the *Dustex master*)

With the aid of the extraction duct kit (please refer to the accessories list), a *Dustex master* can be upgraded to a *Dustex master plus*.

The following retrofit tasks are required in order to do this:

- Remove the base grate (Figure 9).
- Push the extraction duct towards the back so that the connecting piece in the opening engages on the rear wall.
- Press the front of the extraction duct onto the ball pins, making sure it snaps in place (Figure 10).

4.5 Reversing the View Pane

The view pane has a plastic coating on one side.

The eye protection symbol provides you with an indication as to which side of the pane faces inwards:



on the left

>>> Coated side inwards
(Figure 11)



on the right

>>> Glass side inwards
(Figure 12)

This coating is particularly resistant to the abrasive particles and dust generated during grinding.

However, when grinding and milling components containing acrylics, electrostatic charges may cause dust and particles to adhere to the coating.



Polishing agents containing solvents may also damage the coating.

In such cases, the viewing pane can be reversed so that the uncoated side faces inwards.

The following steps are required in order to do this:

1. Loosen the screws (Figure 13).
2. Pull the pane out (Figure 14).
3. Reverse the pane.
4. Reinsert the pane (Figure 14).
5. Retighten the screws (Figure 13).

4.6 Armrests (Figure 15)

Armrests can be installed on the *Dustex master (plus)* to help relieve strain during work with the unit (please refer to the accessories list).

Installation instructions are provided with the armrests.

4.7 Magnifier (Figure 16)

A magnifier attached to a flexible arm can also be installed on the extraction box (please refer to the accessories list).

Installation instructions are provided with the magnifier.

5. Cleaning / Maintenance

5.1 Cleaning the Interior

- Use only solvent-free cleansers (e.g., soapy water).
- Remove the base grate or extraction duct and vacuum out the chamber (Figure 17).
- The extraction grate can be removed in order to clean the extraction duct (Figure 18).

5.2 Replacing the Viewing Pane

Please refer to the installation instructions provided with the new view pane.

5.3 Replacing the Wood Support

The wood support can be easily replaced if it becomes damaged as a result of grinding work or simply becomes unsightly with age:

- In order to remove the wood support, lift it off (Figure 19).
- Push a new wood support with ball pins into the bore hole on the extraction duct, making sure it snaps in place (Figure 19).

5.4 Replacing the Fluorescent Lamp



Disconnect the unit from the mains power supply before changing the fluorescent lamp!



Never press on or bend the lamp body during replacement (breakage risk). If necessary, wear gloves or use a cloth.

1. Loosen the knurled nuts on the lamp cover (Figure 5).
2. Remove the cover (Figure 4).
3. Pull the fluorescent lamp horizontally out of its socket (Figure 2).
4. If possible, vacuum out the socket.
5. Insert the new fluorescent lamp horizontally into the socket (Figure 2).
6. Reinstall the cover (Figure 4).
7. Retighten the knurled nuts (Figure 5).

6. Spare Parts

Please refer to the enclosed spare parts list for the spare / replacement part numbers.

7. Warranty

Provided the unit is properly used, Renfert **warrants** all components of the *Dustex master* and *Dustex master plus* for a **period of 3 years**.

The original sales receipt from the dealer must be provided when making warranty claims.

Components subject to natural wear (e.g., fluorescent lamps, view panes, wood supports, etc.) are excluded from this warranty. The warranty is voided in case of improper use; failure to observe the operating, cleaning, maintenance, and connection instructions; in case of independent repairs or repairs by unauthorized personnel; if spare parts from other manufacturers are employed, or; in case of unusual influences or influences not in compliance with the utilization instructions. Warranty service shall not extend the original warranty.

8. Technical Specifications

Mains voltage:	230 V, 50 Hz 120 V, 60 Hz
Power consumption, lighting:	17.3 W (230 V) 9.5 W (120 V)
Power cord length:	2 m [78.74 inches]
Ø, extraction connectors for external extraction:	
Internal:	35 mm [1.38 inches]
External:	40 mm [1.58 inches]
Dimensions (WxHxD):	380 x 285 x 400 mm [14.97 x 11.23 x 15.76 inches]
Extraction chamber (volume):	17 l
Weight :	5 kg

9. Standard Delivery

- 1 Extraction box
- 1 Fluorescent lamp with lamp cover
- 1 Operating instructions, with attachments
- 1 Spare parts list
- 1 Base grate (only for part no. 2626-0000 and 2626-1000)
- 1 Extraction duct, complete (only for part no. 2626-0100 and 2626-1100)

10. Delivery Versions

- No. 2626-0000 *Dustex master*, 230 V, 50 Hz
- No. 2626-1000 *Dustex master*, 120 V, 60 Hz
- No. 2626-0100 *Dustex master plus*, 230 V, 50 Hz, w. extraction duct
- No. 2626-1100 *Dustex master plus*, 120 V, 60 Hz, w. extraction duct

11. Accessories

- No. 2626-0200 Extraction duct kit to upgrade the *Dustex master* to a *Dustex master plus*
- No. 2626-0300 Magnifier with holder
- No. 2626-0400 Armrests

12. Troubleshooting

Problem	Possible cause	Corrective action
Insufficient extraction power.	<ul style="list-style-type: none">• Extraction duct blocked.• Extraction grate blocked..	<ul style="list-style-type: none">• Remove and clean the extraction duct.• Remove and clean the extraction grate.
Lamp does not switch on.	<ul style="list-style-type: none">• Power cord not plugged in.• Faulty fluorescent lamp• Faulty electronics• Fluorescent lamp not properly seated in its socket.	<ul style="list-style-type: none">• Plug the power cord in.• Replace the fluorescent lamp (refer to Sec. 5.4).• Have Customer Service replace the electronics or refer to the Spare Parts List.• Refer to Sec. 4.2, "Installing the Fluorescent Lamp".

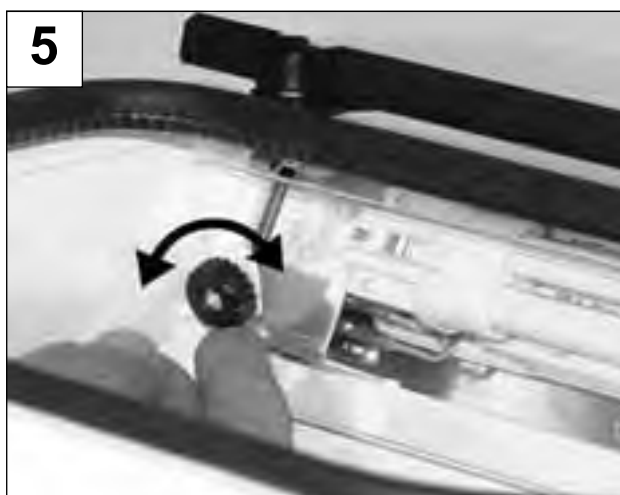
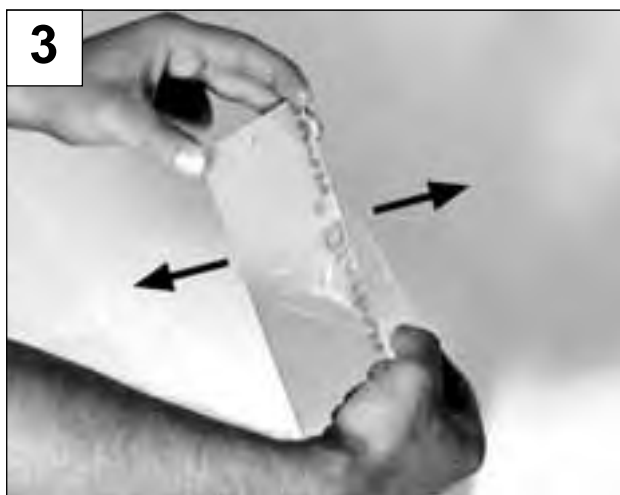

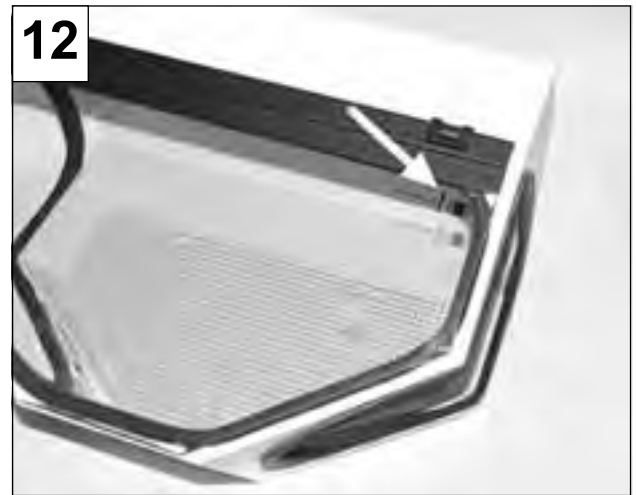
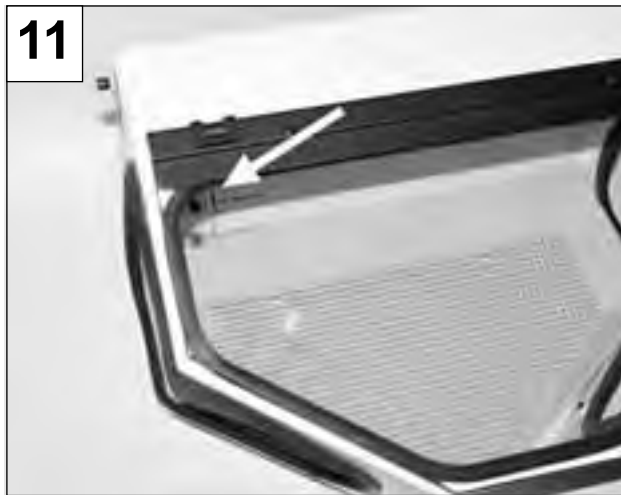

17



18



19

